

Stair Climbing System

C-max

Translation of the original user's manual



Ideen bewegen mehr



CE Declaration of conformity

The company AAT Alber Antriebstechnik GmbH herewith declares that the products of the stair climbing system **C-max** were developed and manufactured in concordance with the current regulations of the European Union, EEC Guidelines 93/42/EWG.

This declaration becomes void if the above mentioned devices have been altered without the consent of AAT Alber Antriebstechnik GmbH.



Signature of the manufacturer:

Markus Alber
Managing shareholder
AAT Alber Antriebstechnik GmbH

The stair climbing system **C-max** has been tested successfully according to the ISO/FDIS 7176-23 by the Technical University Berlin.



AAT Alber Antriebstechnik GmbH

P.O. Box 10 05 60 · D-72426 Albstadt
Tel.: +49 - 74 31 - 12 95 0 · Fax.: 12 95 35
info@aat-online.de · www.aat-online.de

Table of contents

	CE Declaration of conformity	2
	Table of contents	3
1	General information	5
1.1	Instruction	5
1.2	Care and maintenance	5
1.3	Warranty and liability.	5
2	Description of the product.	6
2.1	Adequate use	6
2.2	Features of the c-max	7
2.3	Technical data.	7
3	Assembly.	8
3.1	Attach the back rest to the climbing frame	8
3.2	Affix the back rest	8
3.3	Attach the C-part plus seat to the climbing frame	8
3.4	Affix the C-part	8
3.5	Helix cable	9
3.6	Attach the battery pack.	9
3.7	Detach the battery pack	9
3.8	Arm rests	10
3.9	Handles	10
4	Safety instructions	11
4.1	Instruction	11
4.2	Safety brakes	11
4.3	Lining of the climbing foot	11
4.4	Lifting capacity	11
4.5	Care and maintenance	11
4.6	Condition of paths, walkways etc.	11
4.7	Charge of the batteries	11
4.8	Transport	11
5	Operation	12
5.1	Maximum lifting capacity.	12
5.2	Control light	12
5.3	Helix cable connector	12
5.4	Battery pack.	12
5.5	Safety brakes	12
5.6	Lining of the climbing foot	12
6	Instructions for operation	13
6.1	Operational components	13
6.2	Single step control	14
6.3	Climbers	15
6.4	Safety brakes	15
6.5	Transportation of person with the c-max	16
6.6	Operation on level ground	17
6.7	Adjust the handles	17
6.8	Tilting the stair climbing system	18
6.9	Operation on slopes	18
6.10	Climbing upstairs	19
6.11	Climbing downstairs	22
6.12	Laying the c-max on the stairs	24
6.13	Transport	24



7	Accessories	25
7.1	Battery pack	25
7.2	Exchange the battery pack	25
7.3	Charging cable for your vehicle	25
8	Care and maintenance	26
8.1	Charger	26
8.2	Battery pack	27
8.3	Sealed lead acid batteries	27
8.4	Charging the battery pack	28
8.5	Fuses	28
8.6	Tighten driving chain	29
8.7	Check brake lining	29
8.8	Check the climbing foot's lining	29
8.9	Cleaning	30
9	Warranty and liability	31
9.1	Warranty	31
9.2	Liability	31

1 General information

Congratulations! With the acquisition of this stair climbing system you have a device that will quickly become a reliable and indispensable partner in transporting physically disabled people.

With the **c-max** you are able to transport persons safely and effortlessly up- and downstairs; even winding stairs are no problem for the **c-max**.

Driving on slopes is also possible. The safety brakes on both sides of the **c-max** ensure your safety.

Naturally the **c-max** is also suitable to drive on level ground. The device is lightweight, flexible and does not take up much space.

The **c-max** is capable of climbing stairs up to a step height of 21 cm. The minimum depth of the step's surface must be 14 cm, regardless of the type of stairs (regular straight stairs or winding stairs).

The necessary step width concerning straight stairs is the width of the **c-max** plus an extra 10 cm for manoeuvring.



1.1 Instruction

This user's manual will instruct you step by step about the safe and adequate use of the **c-max**.

Operating the **c-max** takes a certain skill. In the interest of your safety only trained personnel may use the **c-max**.



Please read this user's manual carefully and particularly take note of the safety instructions before you use the **c-max** for the first time.

1.2 Care and maintenance

One of the most important aspects concerning the maintenance of the **c-max** is charging the sealed lead acid batteries. They are part of the battery pack and must be charged every time after using the device.

Other than that your **c-max** does not need much care or maintenance. More extensive instructions you find in chapter 8.

1.3 Warranty and liability

For damage that was caused by inadequate use disregarding this manual we assume no liability whatsoever. (Please read chapter 9 for more detailed information concerning warranty and liability).

2 Description of the product

2.1 Adequate use

Please use the **c-max** exclusively for the transportation of physically disabled persons.

Said persons should be able to sit properly without help, otherwise you should secure them with a safety belt. The latter is an accessory available at AAT Alber Antriebstechnik GmbH.

In addition, the arms of the person to be transported should not protrude over the arm rests during the transportation process.

- ☞ In the interest of your safety you may not use the stair climbing device **c-max** on escalators or moving belts!
- ☞ Transporting other kinds of loads is explicitly prohibited!
- ☞ Only authorized operators may use the s-max. Therefore never leave the s-max unattended.
- ☞ Please do not use the c-max in the rain or generally in wet conditions due to the following potential safety hazards, e.g. danger of slipping, restricted braking effect etc.



Driving on level ground



Mastering stairs



Driving on slopes

2.2 Features of the c-max

- 1 = control unit
- 2 = handles, adjustable
- 3 = back rest
- 4 = arm rest, swivels out
- 5 = C-part plus seat
- 6 = climbing frame
- 7 = foot rest, folds in
- 8 = main wheel
- 9 = lever with chain drive
- 10 = climber and climbing foot
- 11 = safety brake
- 12 = power unit
- 13 = battery pack
- 14 = tightening knobs for the back rest
- 15 = single step switch
- 16 = tightening knob for the handle



2.3 Technical data

measurements	height = 1090 mm width without arm rests = 440 mm width with arm rests attached = 485 mm depth with the foot rest folded in = 730 mm depth with the foot rest folded out = 915 mm
weight	climbing frame = 17,2 kg, C part plus seat = 4,6 kg, back rest = 4,3 kg, both arm rests = 1,2 kg, battery pack = 4,4 kg, total weight = 31,7 kg
maximum lifting capacity	120 kg
batteries	2 x 12 V / 5 Ah sealed lead acid
direct current motor	24 V
climbing speed	8 - 23 steps / minute, continually adjustable
capacity with one battery pack	15 - 30 floors, depending on the load
maximum height of step	21 cm
noise level	the device's A weighted noise level lies typically below 70 dB (A)
Storing/operating temperature,device	0° C up to + 60° C / - 30° C up to + 50° C
Storing/operating temperature,batteries	0° C up to + 60° C / - 30° C up to + 50° C
vibrations	the weighted RMS value of acceleration the upper body is exposed to lies typically below 2.5 m/s ²

3 Assembly

With a few movements you can assemble the **c-max** by means of several fixtures and tightening knobs. Disassembly is just as easy.

3.1 Attach the back rest to the climbing frame

Put the back rest onto the guide pins on top of the climbing frame.



3.2 Affix the back rest

Fix the back rest tightly to the climbing frame with the two tightening knobs.

- ☞ Always make sure that the back rest is securely fastened to the climbing frame.

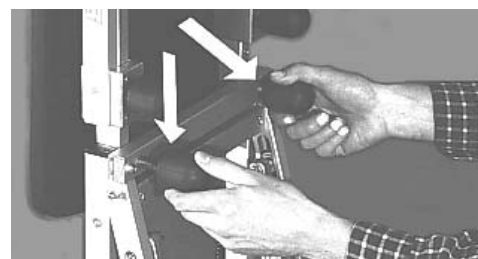

3.3 Attach the C-part plus seat to the climbing frame

Put the C-part plus seat onto the climbing frame; the locating bolts of the C-part fit into the corresponding holes in the frame.



3.4 Affix the C-part

Fix the C-part tightly to the climbing frame with the two tightening knobs.

- ☞ Always make sure that the C-part plus seat is securely fastened to the climbing frame.

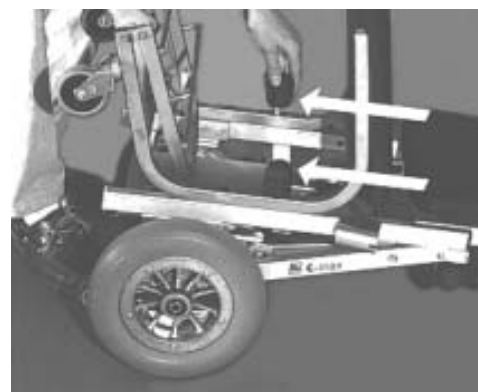

3.5 Helix cable

Put the connector of the helix cable into its socket located on the power unit's housing. Lock the connector by pushing up the latching.



Be cautious that neither connector nor socket become wet by e.g. water or snow - this may cause a short circuit between pins and result in severe malfunction of the system



3.6 Attach the battery pack

Push the battery pack into its fixture by means of the guiding pins on top of the power unit's housing. This establishes the power connection and locks the battery pack.



3.7 Detach the battery pack

Unlock the battery pack by pressing the release button on top of the battery pack until it engages. Then lift out the battery pack.



3.8 Arm rests

Insert arm rests on both sides.

- ☞ Please always make sure that the stop bolts snap in their appropriate notches.



3.9 Handles

Adjust handles to the appropriate height ❶ on both sides (see chapter 6.7) then fasten them with the tightening knobs ❷.

- ☞ After adjusting the handles, always make sure that they are securely fastened.

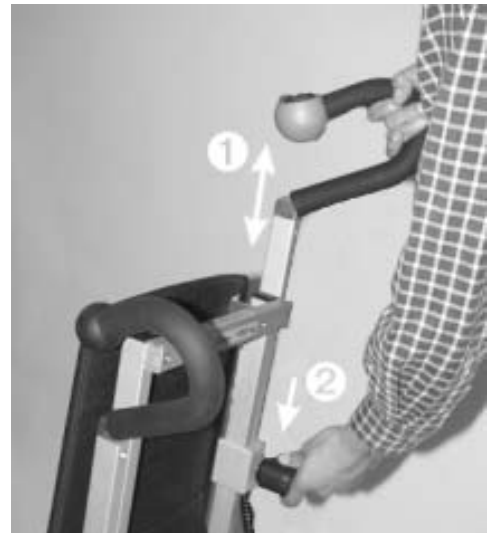

4 Safety instructions

 For the safe operation of the **c-max** it is highly important that you pay close attention to all instructions regarding operation and safety stressed in this user's manual.

4.1 Instruction: The **c-max** may only be operated by trained personnel. In addition, the operator should be capable of lifting 1/3 of his or her own weight. Minors are not allowed to use the **c-max**; exempt from the above are adolescents over 16 years of age who have been trained under supervision to operate the **c-max**. While using the **c-max** you should always wear good shoes that do not slip.

4.2 Safety brakes: Please check the safety brakes each time before using the **c-max** (see also chapter 6.4 and 8.9). The safety brakes, particularly the knurled surface of the brake drums in the wheel rims, must be cleaned weekly with alcohol to ensure the optimum braking effect.

 Never use suds or greasy cleaners.

After cleaning the safety brakes must be checked as described in chapter 6.4

4.3 Lining of the climbing foot: Please check regularly whether the lining of each climbing foot is still sufficient (see chapter 8.10).

4.4 Lifting capacity: The stated maximum lifting capacity may not be exceeded. Please also read chapter 5.1.
You may under no circumstances use the **c-max** to transport goods.

4.5 Care and maintenance: Please make sure that you charge the battery pack after each use of the **c-max**.
When the **c-max** is at a standstill for a while, please turn the device off, i.e. the ON/Off switch needs to be on **0**.
If the working elements of the device block, turn the **c-max** off immediately.

 Repairs may be done by authorized dealers or the manufacturer only. Please exclusively use AAT Alber parts and accessories.

Please note the extensive care and maintenance instructions in chapter 8.

4.6 Condition of paths, walkways etc.: Please make sure that the paths and walkways you use with the **c-max** are free of obstacles and not slippery. Avoid operation on damaged stair linings, snow, ice, etc.

 The **c-max** may not be used in wet and rainy conditions.

4.7 Charge of the batteries: You should only use the **c-max** with fully charged batteries. In case the batteries run low on the stairs (a sequence of 3 flashes repeated every 2.5 seconds) the available charge of the batteries is sufficient to transport the person safely to the bottom of the stairs. Driving downstairs the motor works as a generator, thus recharging the batteries. The potential steps downward, therefore, are not limited.

4.8 Transport:

 Make sure you never lift the device at the frame (see chapter 6.13).

 Also please always turn off the **c-max** for transportation!

5 Operation

5.1 Maximum lifting capacity

Please make sure that the maximum lifting capacity is not exceeded.

5.2 Control light

After turning on the device, the control light ❶ should light up and stay on. Flashing of the control light indicates malfunction.

Further information on malfunction you find in chapter 6.1.4

5.3 Helix cable connector

Check whether the connector of the helix cable ❷ is plugged into the housing of the power unit and locked each time before you use the **c-max**.

5.4 Battery pack

Please make sure that the sealed lead acid batteries ❸ are fully charged before you use the **c-max** for the first time.

Extensive instructions you find in chapter 8.4.

5.5 Safety brakes

Before operating the **c-max** check the safety brakes ❹ every single time. Extensive instructions you find in chapter 6.4.

5.6 Lining of the climbing foot's lining

Please check regularly whether the lining on each climbing foot ❺ is still sufficient.

Further instructions you find in chapter 8.10.

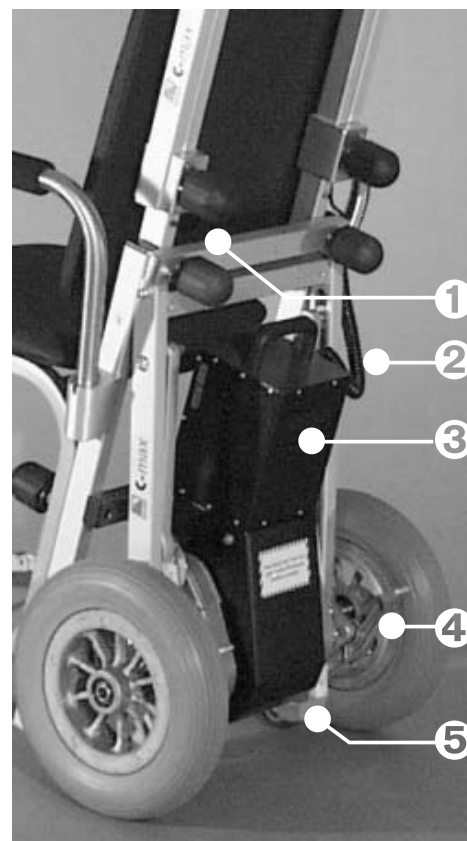

6 Instructions for operation

Before we get to the actual instructions for operation, we would like to introduce the **c-max**'s most important components to you:

6.1 Operational components

The control unit is situated on the right handle and consists of an UP/DOWN switch **1**, a speed control **2**, a safety chip for the engine immobiliser **3** and an ON/OFF switch **4**.

☞ It is possible to supply you with a left-handed control for additional charge.



6.1.1 ON/OFF switch

During a longer standstill, please turn the **c-max** off by pushing the rocker switch **4** on "O".

The **c-max** is equipped with an electronic turn-off mechanism, i.e. if the device is on and not in use for about 5 minutes, it turns itself off automatically.

In such case you need to turn the device first OFF and then ON again.

6.1.2 UP/DOWN switch

With the UP/DOWN switch **1** you activate the climbing mechanism up- or downstairs.

6.1.3 Speed control

The speed control **2** enables you to adjust the speed continuously.

When you use the **c-max** for the first time, please choose the lowest speed.

6.1.4 Safety Chip for the engine immobiliser

The Up/Down switch only works if you put the safety chip for the engine immobiliser into its slot. Please make sure that the chip is properly set to ensure safe and continuous operation.

If you do not put in the chip you can turn on the s-max, but you cannot drive with it. This feature makes sure that no unauthorized person uses the device.

6.1.5 Control light to indicate malfunction

After turning on the **c-max** the green control light (LED) lights up and remains lit, which indicates that the stair climbing system is in order and ready to use.

Potential malfunction is indicated by a light diode. After a period of 3 seconds each time a blinking signal is repeated.

In case of malfunction, turn the device first off and then on again. If there is still an indication of malfunction, charge the batteries in case of low battery charge. For all other cases of malfunction, please call your local dealer.



Number of flashes	Indicated malfunction
1	overload of the device
2	battery pack, undervoltage
3	overvoltage
4	UP/DOWN switch or its supply line is damaged
5	defective electromagnetic brake
6	malfunction of electronics

6.2 Single step control

The single step switch is located on the climbing frame (see pictures).

Please activate the single step mode to practise and in particular to climb winding stairs.

If you activate the ON/OFF switch in that mode, the device will climb only one step at a time. The climbing system stops in the correct position, even if you press the ON/OFF switch continuously.

The climbing mechanism cannot unintentionally be activated. You can take your time to move the main wheels to the next step's edge.

 To continue climbing you simply release the UP/DOWN switch and then press it again.



The arrows with the dotted line symbolize the interruption of the climbing process, i.e. the single step mode is activated. To do that you press the rocker switch on **I**. By contrast, if you press the rocker switch on **O** it signifies the uninterrupted climbing process, i.e. the single step mode is **OFF**.

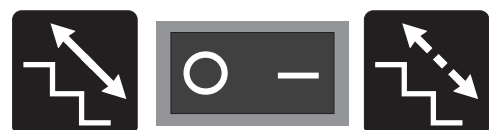

6.3 Climbers

The climbers (see picture) must be pulled in to topmost position by means of the UP/DOWN switch if you want to :

- drive on level ground and on slopes
- check the safety brakes
- begin climbing upstairs or downstairs



6.4 Check safety brakes

There are safety brakes located on the climbing frame on both sides.

 Please check the safety brakes each time before you use the **c-max**.

You may check the brake effect either on top of the stairs or on level ground as described in 6.4.1 and 6.4.2.



6.4.1 Test the required brake effect

Tilt the **c-max** backwards until the back rest is in an almost horizontal position (see picture).

If the **c-max** cannot be pushed forward by the handles in said position, but merely rolls backwards, then the required brake effect for the safe operation of the **c-max** is granted (see picture).

6.4.2 Test the required brake effect at the top edge of the stairs

 Please make this test without a person sitting in the chair.

Tilt the device backwards to its regular climbing position (see chapter 6.8) and drive forward to the first step's edge. If you cannot push the device over the edge of the step, the required braking effect for a safe operation of the **c-max** is granted.

 **Important:** If the required brake effect is not guaranteed, you may, under no circumstances, use the **c-max** any more. Please contact your local AAT Alber dealer or the manufacturer immediately.



6.5 Transportation of people with the **c-max**

Please note that the **c-max** was developed to be operated by one person. Always use both hands when using the device.

- ☞ Please practice driving with the **c-max** on level ground, slopes and climbing up- and downstairs at first without a person sitting in the chair! Whenever you practice, please make sure that nobody is standing in the potentially dangerous spot directly below the **c-max** on a slope or stairs.

We suggest that you practice climbing up- and downstairs with the single step mode activated (see chapter 6.2). Also choose the lowest climbing speed for practicing (see chapter 6.1.3)

- ☞ Please do not exceed the maximum lifting capacity (see chapter 5.1)
- ☞ In the interest of your safety please always operate the s-max from behind, never sideways.

When seating a person on the **c-max** please be aware of:

6.5.1 Secure stand of the **c-max**

When a person is seated on the **c-max**, the device must stand securely on the ground. Therefore the climbers must be extended in such a way that they touch the ground and support the device (see picture).

Turn the **c-max** on by pressing the ON/OFF switch.

Now activate the UP/DOWN switch direction UP until the climbers touch the ground.

6.5.2 Swivel out or remove the arm rests

When a person is seated, the arm rests can be swivelled out or, if necessary, removed entirely. After the person is seated, please bring the arm rests into their original position.

6.5.3 Fold out the foot rest

When a person is transported, please fold out the foot rest (see picture), and, if necessary, help the person to place his/her feet on it.



6.6 Operation on level ground

After the person has been properly seated, you may transport him or her effortlessly on level ground (see picture)

- ☞ Passing over thresholds pulling the **c-max** backwards is much easier than pushing it forwards over them.



6.7 Adjust the handles

For climbing stairs or driving on slopes, comfortably and safely, adjust the height of the handles approximately to the level of the operator's shoulders.

- ☞ After adjusting the handles, always make sure that they are securely fastened.



6.8 Tilting the stair climbing system

To drive on slopes or to climb stairs you must tilt the **c-max**, which can be done easily by means of the climbers.

1. Turn on the **c-max** by pressing the ON/OFF switch.
2. Press the UP/DOWN switch direction DOWN until the climbers lift the main wheels at least 1-2 cm off the floor (see picture).
3. Put your foot on the power unit's housing and tilt the **c-max** slightly toward you until you feel that the **c-max** is balanced.
4. The **c-max** is balanced if you feel neither pull nor push in the handles.
5. In order to drive on level ground, the climbers must be pulled in entirely

If you tilt the **c-max** further, or too much, the safety brakes engage and the **c-max** can't be moved forward any more.



6.9 Operation on slopes

To drive on a slope, make sure the handles are adjusted appropriately (see chapter 6.7), then tilt the **c-max** slightly backwards (see chapter 6.8).

- ☞ For safety reasons we recommend you to ask another person to assist when driving on a slope..

6.9.1 Downhill

Drive forward to the edge of the slope. In order to slow down you need to tilt the **c-max** a bit more.

6.9.2 Uphill

Please drive backwards up a slope. In order to slow down you need to tilt the **c-max** a bit more.



6.10 Climbing upstairs

- ☞ Please always practice climbing stairs without a person and by activating the single step mode plus the lowest climbing speed.

The climbing process can be accomplished quickly and without problems if you adhere closely to the following instructions.

A tip before you start:

- ☞ During the climbing process always pull the **c-max** slightly towards you, so that the device automatically moves to the next higher step.
1. Adjust the handles to the appropriate height (see chapter 6.7)
 2. Turn the **c-max** on by pressing the ON/OFF switch.
 3. Activate the single step mode if necessary (see chapter 6.2)
 4. Pull in the climbers to their topmost position by pressing the UP/DOWN switch (see chapter 6.3).
 5. Tilt the **c-max** slightly toward you (see chapter 6.8).
 6. Drive backwards to the stairs ❶ and move up 2 to 3 steps ❷



Now the **c-max** is in its initial position for climbing upstairs.

- ☞ Make sure that both main wheels touch the lowest step ❸



7. The climbing process takes place in two intervals.

The first interval starts by pressing the UP/DOWN switch, direction **UP**. The climbing process begins here with the power unit initiating the movement of the climbers downward ❶



8. After the climbers ❷ reach the floor, they assume the load of the main wheels while the main wheels and the frame ❸ are lifted at the same time.

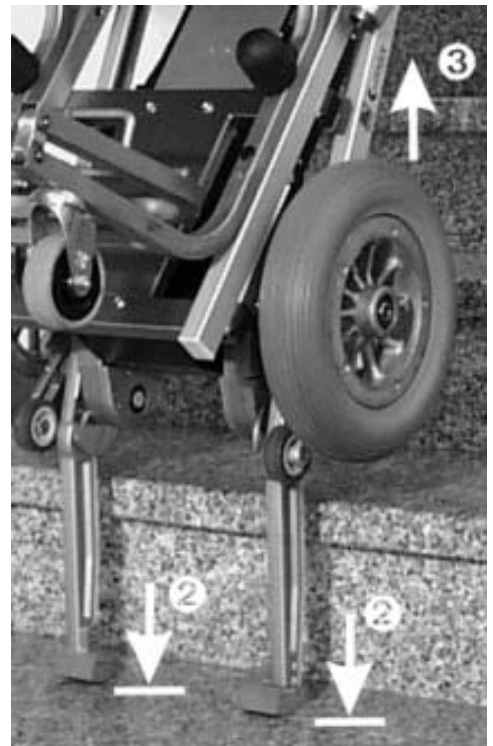

9. The first interval is finished when the main wheels touch down on the next higher step ④ and resume the load of the climbers.
10. The second interval begins by pulling in the climbers ⑤. It is finished when the climbers reach their topmost position.

If you activated the single step mode, the climbing process ends at this point. To resume climbing you need to press the UP/DOWN switch once again, direction **UP**.



Because the **c-max** is always pulled slightly backward, it rolls automatically to the next step and reaches the initial position again.

At this point the climbing process repeats itself as described in point 7.



6.11 Climbing downstairs

- ☞ Please always practice climbing downstairs without a person, and by activating the single step mode plus the lowest speed.

The descending process can be accomplished quickly and without problems, if you adhere carefully to the following instructions.

1. Adjust the handles to the appropriate height (see chapter 6.7)
2. Turn on the **c-max** by pressing the ON/OFF switch.
3. If appropriate, activate the single step mode (see chapter 6.2).
4. Pull in the climbers completely by means of the UP/DOWN switch (see chapter 6.3).
5. Tilt the **c-max** slightly (see chapter 6.8).
6. Drive the **c-max** forward to the edge of the stairs ❶.



7. The sensitive rolls ❷ of the brakes keep the **c-max** from rolling over the edge.



8. Press the UP/DOWN switch, direction **DOWN**, and the descending process begins.
9. The power unit moves the climbers **3** down.



10. When the climbers reach the next lower step **4**, they resume the load of the main wheels, while those plus the climbing frame are lifted off the higher step **5**.



11. Now the main wheels and the climbing frame are moved forward ⑥

Then the main wheels plus the climbing frame are lowered ⑦ by pulling up the climbers ⑧ until...

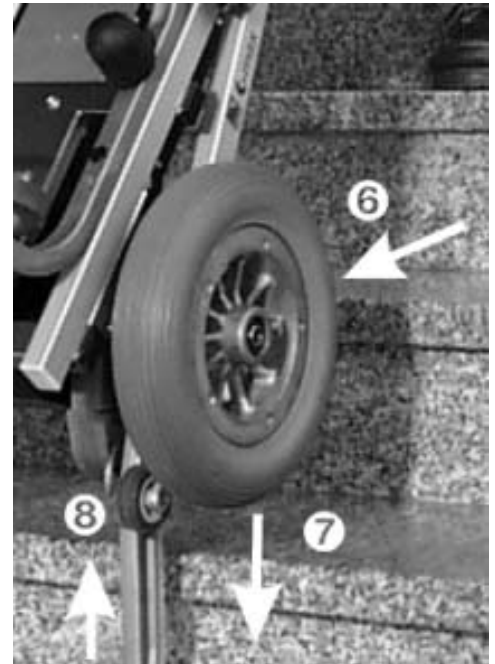

12. ...the main wheels touch down on the next step (see picture).

If you activated the single step mode, the climbers are pulled in entirely and then the descending process ends at this point.



13. Again push the **c-max** all the way to the edge of the step, i.e. until the sensitive rolls of the security brakes stop the **c-max**.

To continue descending you need to press the UP/DOWN switch again, direction DOWN, if you activated the single step mode.

Climbing downstairs now repeats itself as explained in point 7 and following.



6.12 Laying the c-max on the stairs

In an emergency you may lay down the **c-max** on the stairs. The security brakes prevent the **c-max** from rolling down (see picture).



6.13 Transport

You may remove the seat of the c-max for transportation (see chapter 3). Should you prefer to transport the c-max with the seat, please lift it at both the grip and the seat.

- ☞ Make sure you never lift the device at the frame!
- ☞ Also please always turn off the c-max for transportation!

7 Accessories

7.1 Battery pack

The **c-max** works with batteries and is delivered with one battery pack.

Additional battery packs, we call them quick release battery packs, are available as an accessory.

We recommend an additional battery pack if you use the **c-max** continuously, i.e. there are not sufficient breaks for the batteries to be recharged.

In such case one battery pack is in use while the other is being recharged at the same time.

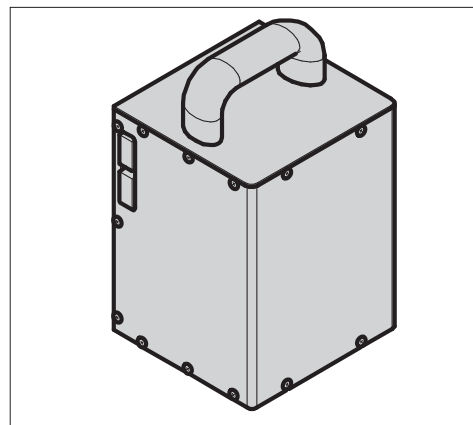

7.2 Exchange battery pack

1. Turn off the **c-max** using the ON/OFF switch.
2. Press the release button ❶ on top of the battery pack ❸ until it engages. Now you lift out the battery pack at its grip ❷ from its fixture on top of the power unit's housing ❹.
3. Push the other fully charged battery pack from the top into its fixture by means of the guiding pins on top of the power unit's housing. This establishes the power connection and locks the battery pack.

☞ The quick release battery pack should always be connected to the charger to extend its durability (see chapter 8.4).

☞ Please exclusively use the **AAT Alber charger** to charge your battery pack.

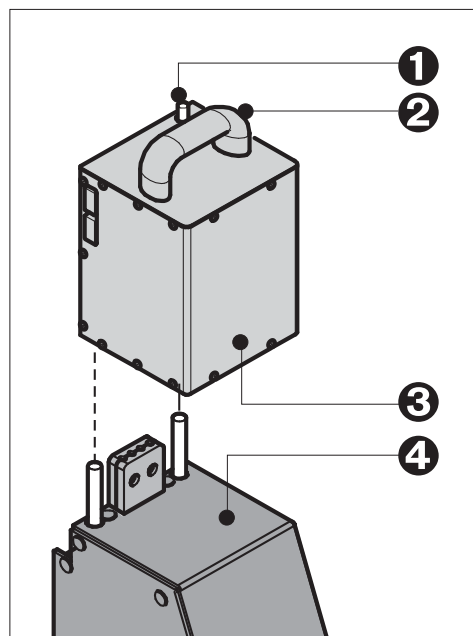

7.3 Charging cable for your vehicle

A charging cable for your vehicle is recommended, if you transport the **c-max** frequently in your car. The charging cable is available as an accessory.

The charging cable's plug ❶ fits into the socket of the car's cigarette lighter; connect the other plug ❷ to the battery pack.

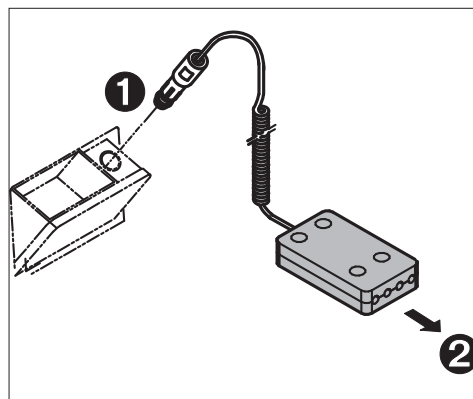

8 Care and maintenance

To guarantee the safety of the **c-max** the device must be inspected every two years, even if there are no outer signs of damage or malfunction.

☞ In the interest of your safety repairs of any kind may only be done by personnel authorized by AAT Alber Antriebstechnik GmbH.

The device itself (as opposed to the batteries) does not need any particular maintenance except for an occasional cleaning (see chapter 8.9).

8.1 New user

If the device goes to a new user, we recommend a safety check.

8.2 Charger

Please exclusively use the AAT Alber charger to charge your battery packs.

8.2.1 Automatic charger

The **c-max** comes with the automatic charger. The charging cable's plug ❶ fits into the wall outlet socket; connect the other plug ❷ to the battery pack.

This automatic charger recharges your batteries 100%. As soon as the charging process is completed, it switches to a retaining mode, thus overcharging is impossible.

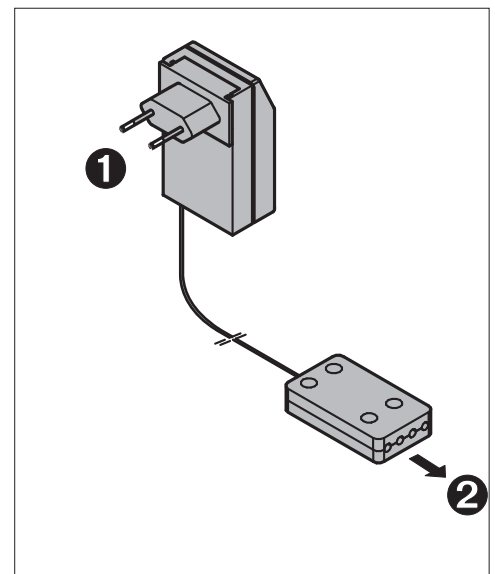

8.2.2 Charging cable

A charging cable for your vehicle is available as an accessory. Approximately a recharge of 80% is possible by accessing your vehicle's battery using a charging cable. Connector ❶ fits to the cigarette lighter; plug in connector ❷ at the battery pack.

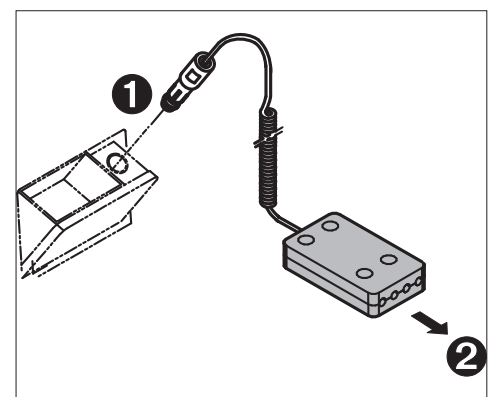

8.3 Battery pack

The quick release battery pack, consisting of sealed lead acid batteries, should be recharged after each use. (Technical details for the sealed lead acid batteries you find in chapter 8.3)

Tip:



If the **c-max** is at a standstill for some time, please connect it to the charger to retain the charge. This does not damage the sealed lead acid batteries, on the contrary, it increases their durability.

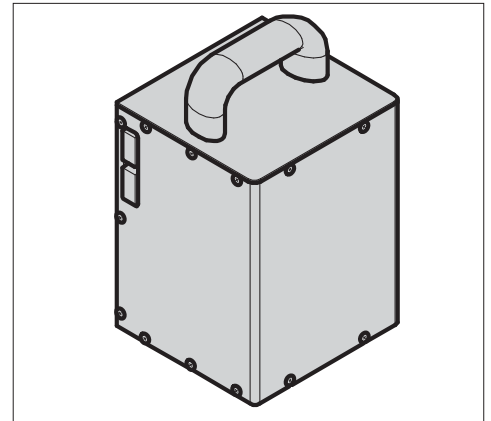

8.4 Sealed lead acid batteries

There are 2 sealed lead acid batteries 12 V / 5Ah in the battery pack of the **c-max**. These batteries are sealed, maintenance free, rechargeable and of top quality.

The batteries of your **c-max** can be discharged or recharged in any possible position.

Please avoid a total discharge: The durability of sealed lead acid batteries depends primarily on the charge/discharge cycle. For instance, you may discharge them partially more than 1000 times and use up the entire capacity more than 200 times, if you avoid a total discharge entirely.

A total discharge does not only lead to a loss of the batteries' capacity, but also shortens their durability. Thus, do avoid a total discharge, by recharging the batteries whenever possible!



Charging your batteries is taking good care of them.

Return dead batteries to AAT Alber Antriebstechnik GmbH or take them to particular recycling places where they can be recycled appropriately.

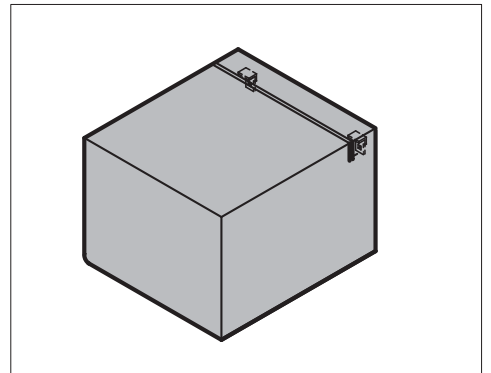

8.5 Charging the battery pack

1. Remove the battery pack from the power unit (see chapter 7.2)
2. Connect the charger's plug ❷ to the socket on the battery pack. Remember: The batteries of your **c-max** can be discharged or recharged in any possible position.
3. Depending of the type of charger used, insert the other plug ❶ into the wall outlet or plug it ❸ into the cigarette lighter's socket in your vehicle.

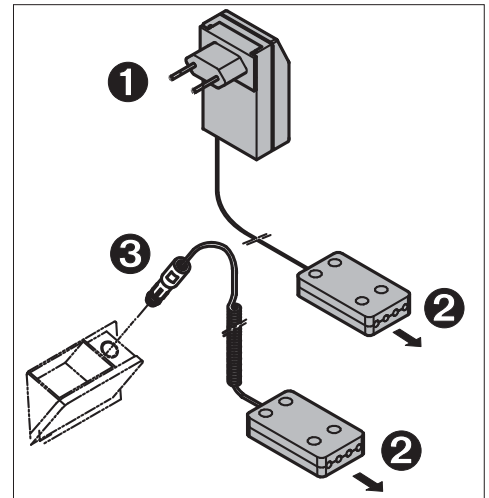

8.6 Fuses

Two electrical 30 A fuses ❶ are located on the side of your battery pack. They are protected by a cover ❷.

 You may not mend or by-pass defect fuses. Always replace them with identical ones of the same amperage.

To exchange the fuses, pull out the cover and the fuses, insert the new ones and replace the cover.

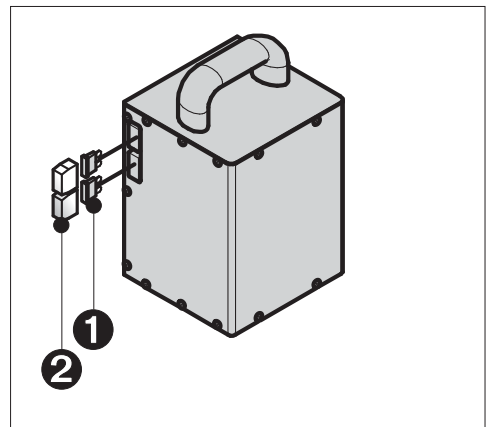

8.7 Check brake lining

Please check the thickness of the safety brakes' lining regularly. The minimum thickness **1** is 1 mm. In case the lining is thinner than 1 mm, the lining must be exchanged on both sides. Please contact AAT Alber Antriebstechnik GmbH or your local dealer.

- ☞ Please check the safety brakes before each use of the **c-max** (see also chapter 4.2 and 6.4).

The safety brakes, particularly the knurled surface of the brake drums in the wheel rims, must be cleaned weekly with alcohol to ensure the optimum braking effect.

- ☞ Never use suds or greasy cleaners.

After cleaning the safety brakes must be checked as described in chapter 6.4.

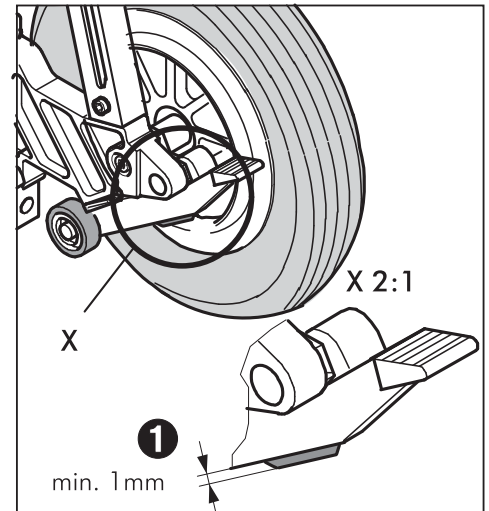

8.8 Check the climbing foot's lining

Please also check each climbing foot's lining **1** on a regular basis.

- ☞ If the lining **1** is worn down to the indicated line **2** or broken, again, exchange both climbing feet.

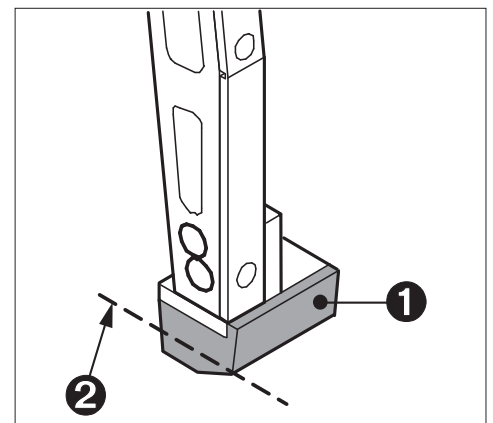

8.9 Cleaning

For the seat's cushion, the back and the arm rests, please use suds.

The other parts of the **c-max** - except the safety brakes (see chapter 8.7) - can be cleaned with a moist cloth; please use regular mild household cleaners.

 For safety reasons, please do not use a high-pressure cleaning device.

 For safety reasons, please do not use a high-pressure cleaning device!

8.10 Recycling

The s-max and its battery pack are products of long durability. However, if your s-max is old and has reached the end of its lifespan you may return its components to AAT Alber Antriebstechnik GmbH or your local dealer to be recycled.

A new law concerning electric and electronic devices (ElektroG) has been passed on March 24, 2005 regulating the taking back and recycling of old electric and electronic devices.

According to the Federal Office of Environment Protection (German BDU) the s-max is considered a means of transportation and does not fall under this law concerning the recycling of old electric or electronic devices (ElektroG, §2 paragraph 1 sentence 1 (cross reference, Guideline of the European Parliament 2002/96/EG)).

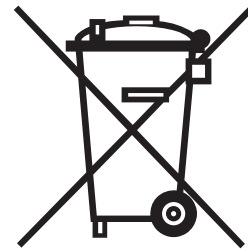

9 Warranty and liability

9.1 Warranty

AAT Alber Antriebstechnik GmbH grants a warranty of two years for all its products of type **C-max** including all its accessory parts (with the exception of the sealed lead acid batteries). The warranty begins at the date of purchase and covers failure of material and errors in manufacturing.

For the sealed lead acid batteries, always assuming correct maintenance, AAT Alber Antriebstechnik GmbH grants a warranty of six months from the date of purchase.

The warranty of the **C-max** does not cover damage or failure caused by:

- inadequate and insufficient maintenance by the client
- inadmissible changes or improper use
- improper use extending the maximum loading capacity of the **C-max**
- inappropriate charging of the sealed lead acid batteries batteries.

9.2 Liability

AAT Alber Antriebstechnik GmbH, manufacturer of the **C-max**, is not responsible for eventual damage done by the following:

- **C-max** was used inappropriately
- repair work, assembly and the like was done by unauthorized personnel
- **C-max** was not operated in accordance with this user's manual
- extraneous parts were attached to or used with the **C-max**.
- parts of the **C-max** were removed
- the **C-max** was loaded extending the maximum loading capacity.









Ideen bewegen mehr

C-max



Ideen bewegen mehr

AAT Alber Antriebstechnik GmbH

Postfach 10 05 60 · D-72426 Albstadt

Tel.: +49 - 74 31 - 12 95 0 · Fax.: +49 - 74 31 - 12 95 35

Email: info@aat-online.de · www.aat-online.de